



THERMOREGULATION

Updated to: 02/2026

- ▶ Thermostats
- ▶ Thermoregulators
- ▶ Temperature probes



- ▶ Mixing valves
- ▶ Zone-valves
- ▶ Accessories

ANTARES
for water & fire

Via degli Alpini, 144 - 55100 LUCCA - ITALY
Tel. +39 0583 473701
ant3@antaresint.com • www.antaresint.com





ANTARES in the world

Management Office:

- ▶ **Italy: LUCCA - Via degli Alpini, 144**
 - Tel. **+39 473701**
 - Mail: **ant3@antaresint.com**
 - WhatsApp: **+39 349 665 6433**
 - Website: **www.antaresint.com**

Manufacturing and distribution branches:

- ▶ **Italy: LUCCA - Via degli Alpini, 144**
- ▶ **Italy: LUCCA - Via Martini, 111**
- ▶ **Romania: BALDOVINESTI - via Propului,76**

Sales Departments:

Belgique

207, Av. Louise bte 4 - 1050 Bruxelles
Tel. (+32) 239 30 597
WhatsApp. (+33) 423 24 3080
www.antaresint.com - be@antaresint.com

Ireland

Mespil House, Sussex Road, Dublin 4
Tel. (+353) 169 944 25
WhatsApp. (+44) 1227 458 684
www.antaresint.com - eire@antaresint.com

România

Str. Ploplui, 76 - Com. Baldovinesti
237005 JUD. OLT
Tel. (+40) 0786 325 646 - Mobil. (+40) 076 058 5909
www.antaresint.com - ro@antaresint.com

Deutschland

Feringastrasse 6 - 85774 Unterföhring
Tel. +49 899 394 8950
WhatsApp +49 01 762 097 7231
www.antaresint.com - de@antaresint.com

Österreich

Landstrasser Hauptstrasse, 71/2 - 1030 Wien
Tel. +49 899 394 8950
WhatsApp +49 01 762 097 7231
www.antaresint.com - at@antaresint.com

U.K.

35 Marine Terrace - Margate, Kent - CT9 1XJ
Telephone & WhatsApp. (+44) 1227 458 684
www.antaresint.com - uk@antaresint.com

España

C/ Martinez Villergas, 49 - 28027 - Madrid
Teléfono & WhatsApp. (+34) 910 626 573
www.antaresint.com - es@antaresint.com

Polska

Ul. Tomaszka Zana 39A 20-634 Lublin
Tel. 00 800 391 1223 **Infolinia bezpłatna**
www.antaresint.com - pl@antaresint.com

France

3 Cours Charlemagne
BP 2597 - 69217 Lyon Cedex 2
Téléphone & WhatsApp. (+33) 423 24 3080
www.antaresint.com - fr@antaresint.com

Portugal

Rua Castilho, n° 23-8° B - 1250 - 067 Lisboa
Tel. 800 83 90 42 **Número Verde**
www.antaresint.com - pt@antaresint.com

INDEX

| | | | |
|---|--------------|--|---------------|
| • Room thermostats ON/OFF | Pag.3 | • Temperature probes for solar panels | Pag.14 |
| • Room thermostats for fan coil units | 5 | • Temp. and sensor probe for biomasses boilers and stoves . | 15 |
| • Humidistats | 5 | • Immersion pockets for thermostats and temp. probes | 16 |
| • Chronothermostats | 6 | • 4-way mixing valves | 17 |
| • Fancoils chronothermostats | 8 | • 3-way mixing valves | 18 |
| • R.F. Chronothermostats | 9 | • Servomotors for mixing valves | 19 |
| • Multi-channel R.F. receiver for thermostats and chronot. | 10 | • Motorised valves and zone-valves | 20 |
| • Electrical connection boxes..... | 10 | • Valves plus actuators..... | 21 |
| • Embedded boxes and adjustment plates for thermostats .. | 11 | • Electronic control units for thermo-fireplaces | 22 |
| • Thermostats and chronothermostats for towel warmers ... | 11 | • Temperature thermo-regulators | 23 |
| • Analogic and electronic embedded thermostats..... | 12 | • Control units and thermostats for solar thermal systems .. | 24 |
| • Digital thermostat with probe | 13 | • Thermostatic mixing valves | 25 |
| • Bimetal thermostat | 14 | | |
| • Temp. probes for thermostats and thermoregulators..... | 14 | | |

Thermostats

Room thermostats ON/OFF

Mechanical



Art. T.001



Art. T.001 – Electromechanical room thermostat. Range 10°C ÷ 30°C. 3 10° switch contacts.

| Item code | Characteristics |
|-----------|-------------------------------|
| T.001.57 | - |
| T.001.51 | With control light and switch |

Electronic



Art. T.002



Art. T.002 – Digital electronic room thermostat with room temperature display. In elegant, flat casing.

Temperature control range 5°C ÷ 35°C. Visual temperature range: 0° C ÷ 45°C. 5° switch contacts, high sensitivity.

| Item code | Thermostat power | Characteristics |
|-----------|--------------------|-------------------------------|
| T.002.02 | 230 V AC o 24 V AC | On-off switch |
| T.002.92 | Pile 2 x "AAA" | On-off switch |
| T.002.93 | Pile 2 x "AAA" | Summer – Off Winter switch |
| T.002.03 | 230 V AC o 24 V AC | Summer – Off Winter switch |

Electronic



Art. T.003.09



T.003.09 – Electronic room thermostat in elegant, flat casing, with ON – OFF switch.

Temperature control range: 5°C ÷ 35°C. power 230 V AC – 50 Hz. Relay: 3 (1) A SPDT.

Radio frequency RF



Art. T.225.00

Art. T.225.00 – RF room thermostat + R.F. receiver for heating systems with radio frequency wireless control signal transmission. Maximum signal distance: 200 mt in open space.

The thermostat transmitter is powered by 2x AA batteries, the receiver is powered by 230 Vac. They can control, wireless and from the distance, a boiler, motorised valve and any electrical appliance. Always paired together, transmitter + receiver can control how many, switching ON and OFF just as many zone valves or any electrical appliance. LCD digital display to display room temperature and set temperature. Wall mounting with white box.

With presence detector PIR

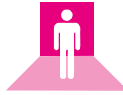

Art. T.008.00

T.008.00 – Digital room thermostat with room presence detector and temperature limiting probe for floor heating.

Power: 230 Vac – Contact: 16 Ampere. Presence detector can be excluded, OFF position. Encased box installment 72 x 72 Art. T.450.60. Allows temperature lowering or system exclusion, if it does not detect the presence of people in the room, for an adjustable time up to two hours. Comes with floor temperature limiting probe (adjustable). Selection and adjustment of two room temperatures: Comfort – Economy: 5 – 45 °C. with anti-freeze function. In AUTO mode, when the infra-red (PIR) detects a person in the room, it selects Comfort temperature; if it does not detect anyone's presence, for a chosen time from 5 min. to 2 hours, it selects Economy temperature. When people are once again detected in the room, it goes back to Comfort temperature. Equipped with temperature limiting probe for floor heating's piping, to limit excessive temperature of floor heating in the event of malfunction of the lowering and mixing temperature control unit of boiler. Adjustable temperature limit of floor heating: 20 – 45° C.

Explosion-proof



Art. T.005.00

Art. T.005.00 – Explosion-proof room thermostat in waterproof casing with spiral sensor, for high-humidity explosive environments.

Range: 0°C ÷ 40°C. 10° switch contacts. Protection level IP 55.

Room thermostats for fan coil units



Art. T.009.01

Art. T.009.01 - Digital room thermostat for fan coil units with room temperature digital display and fan speed control: Maximum, Medium, Minimum. Switch: SUMMER – OFF – WINTER.

Temp. range: 5° ÷ 35°C. display range: 0° ÷ 45°C.
Contacts: 5A. High sensitivity.

With presence detector PIR



Art. T.479.00

Art. T.479.00 - Digital room thermostat with "MOTIONFAN" display for fan coil units FCU with room presence detector and fan speed control (Low-Medium – High). Wall mounted – Power 230 Vac – 6/A.

Equipped with infra-red PIR, allows automatic temperature lowering or system's stop when it does not detect people in the room. Selection and adjustment of two room temperatures: Comfort – Economy: 5-45°C. with anti-freeze function. Presence detector can be excluded, OFF position. In AUTO mode, when the infra-red (PIR) detects the presence of someone in the room, it selects Comfort temperature. If it doesn't detect anybody for an hour, it automatically selects Economy temperature; when it detects someone again, it goes back to Comfort. If nobody is detected for over 8 hours, the systems turns itself off and in Stand-by mode. The display shows the selected temperature and the room temperature, and changes colour from blue to red when room temperature rises.

Humidistats



Art. T.041.00

Art. T.041.00 - Room humidistat. Type EH 392.

For humidity control in air-conditioning systems.
Measure range: 30%-90% U.R. Precision: ± 3%. Protection level IP 20.

Humidistat with thermostat



Art. T.044.00

Art. T.044.00 - Humidistat and thermostat combined in one device with backlit digital display. Wall mounted – Power: 230 Vac.

Display: set values and actual values.
Humidity control range: 30% U.R. Precision: ± 3%.
Temperature control range: 5 - 35 °C
Protection level: IP 20



Art. T.006.04 – Digital chronothermostat with weekly programming, in refined and modern design. With temperature and clock display.

Allows for weekly programming of room temperature. With two adjustable temperature levels. The wide LCD display makes programming easy and helps with the daily setting of the two temperature level, making it especially suited for the elderly. Switch contacts (SPDT) 16° - 250 V.

Art. T.006.04



Art. T.424.99 – Electronic digital "MINITRON 99" chronothermostat with weekly programming, in refined and elegant design. With room temperature and clock display.

Advanced technology design, allows for the programming of different temperatures for every day of the week and the weekends. Temperature control range: 5°C ÷ 35°C. Temperature display range: 0°C ÷ 40 °C. Switch contact (NC-COM-NO). Resistance load: 5°. Equipped with switch: Automatic – Manual – Economy temperature. With antifreeze device. Battery powered: 2x"AAA" (not included).

Art. T.424.99

With mechanical time switch



Art. T.007.24 – Electronic programmable chronothermostat "ALBATROS."

Combines mechanical programming clock and 2-temperature level (adjustable and selectable) electronic thermostat. With daily programming. Battery powered 2 x AA – 4 functions: automatic, day-time manual, night-time manual, off with antifreeze function. Relay switch contact SPDT 8(2)A – 250 Vac. Equipped with led for low-battery signal. Suitable for summer-time air-conditioning.

Art. T.007.24

Two channels: heating and hot water



Art. T.015.02

Art. T.015.02 - "DUOTRON" digital chronothermostat with double weekly programming, independent for the management of the heating system and domestic hot water supply. With room temperature and clock display.

Allows for room temperature programming for every day of the week. Temperature control range: 5°C ÷ 32 °C. Equipped with switch: Automatic – Manual – Reduced temperature. With antifreeze device. Allows for independent switching on and off of domestic hot water supply. Power: 230 Vac – 16 A/250V. Hysteresis: 0,5 °C. Time resolution: 1 minute. Programming time resolution: 10 minutes.

Temperature reduction: 2 – 10 °C



Art. T.016.24

Art. T.016.24 – Electronic daily chronothermostat with 60-minutes programming through up-and-down linear microswitch. Adjustable temperature reduction for range between 2°C and 10°C.

Battery powered. Complete with 4 functions selector: off with antifreeze function, automatic, manual with comfort temperature, manual with reduced temperature. Switch contacts.

Touchscreen

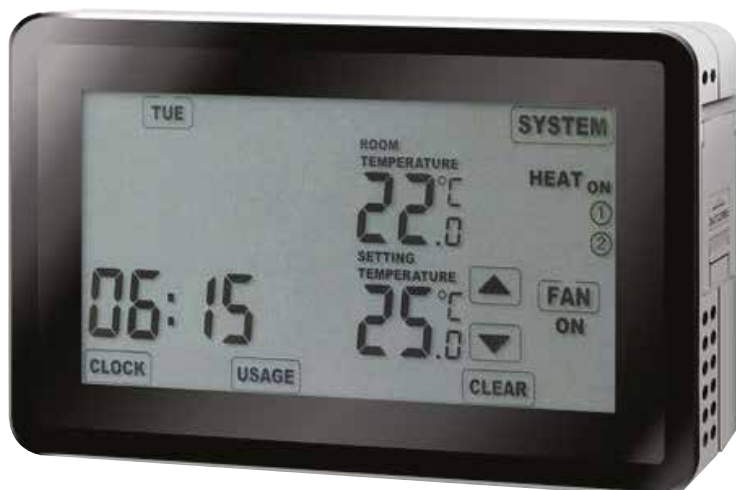

Art. T.460.00

Art. T.460.00 – Digital chronothermostat with touchscreen display. Power: 230 Vac. Commuting contacts SPDT 5/A. Allows for the programming of various temperature in 24h, every day of the week. Comes with wide, backlit touchscreen display.

Touchscreen switch: summer-winter. Antifreeze function.

Temperature control range: 0°-35°C. Room temperature display.

Floor heating systems with probe Wi-fi model as well



Art. T.440

Art. T.440 – INTRON digital room chronothermostat, touchscreen, embedded, with daily and weekly programming. Allows for 4 temperature variation every day of the week. Complete with outside temperature probe (NTC 10 K) for underfloor heating system, to limit and control with a set range the maximum floor temperature.

With removable 3 mt. probe, to be inserted into a floor well. Please see our art. R.148.10.
Power: 230 Vac – Touchscreen backlit display.
Outgoing ON/OFF contact: 16 A.
Room temperature control range: 5° - 40° C.
Room and programming temperature display.
Anti-freeze and stop function. Probe temperature control: 20° - 40°C, pre-set at 30°C. Embedded in box 108 x 74 (503 E).

| Item code | Type |
|-----------|-------|
| T.440.23 | - |
| T.440.53 | WI-FI |



WIFI

Compatible with Amazon Alexa

Compatible with Google home



Art. T.425.00



App-controlled

Voice control

High-energy efficiency

Fire-proof material

Art. T.425.00 – Digital Wi-Fi EVOLUTION embedded chronothermostat. Daily and weekly programming.

Clean contact outlet max. 5°. Power 230 Vac. Can be controlled and programmed through smartphone and vocal control, supported by Google Home and/or Amazon Alexa. Allows for temperature programming in 6 time slots during the day, working days, Saturdays and Sundays. Temperature control range 5-35°C. Embedded in box 72 x 72 (502 E) (Please see art. T.450.60).

Fancoils chronothermostats

Automatic speed control through Δt



Art. T.475.70 - T.475.40



Art. T.475.80 - T.475.50

Art. T.475 – Digital touchscreen “FANTRON” room chronothermostat, with daily and weekly programming. Allows for 4 temperature variations for every day of the week.

If embedded, in box (503 E) 108x74 mm. Power: 230 Vac. Backlit display. With summer-winter switch. Room temperature control range: 5° - 40°. Room temperature and programming display. If in AUTO mode, it allows to automatically change fancoil speed according to room temperature and temperature set on the following version:

Version A: 3 fancoil speed variation: Min. - Med. - Max.

Version B: for suitable fancoils, modulating variation of n° of fan rotations with signal: 0 – 10 or 4-20 mA.

| Item code | Model | |
|-----------|--------------|---------|
| | Fixing | Version |
| T.475.40 | Wall-mounted | A |
| T.475.50 | Embedded | A |
| T.475.70 | Wall-mounted | B |
| T.475.80 | Embedded | B |



WIFI



Compatible with Amazon Alexa



Compatible with Google home



Art. T.476.00



App controlled



Voice control

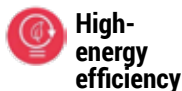

High-energy efficiency



Fire-proof material

Art. T.476.00 – Wifi digital EVOLUTION FCU chronothermostat, embedded for fancoils. Daily and weekly programming.

Speed controller: Low, Medium, High. Switch Summer – Winter. Power 230 Vac. Can be controlled and selected through smartphones and voice control, supported by Google Home and/or Amazon Alexa. Allows for temperature programming in 6 time slots during the day, working days, Saturdays and Sundays. Temperature control range 5-35°C. Embedded in box 72x72 (502 E). see Art. T.450.60.

R.F. Chronothermostats

Transmitter



Art. T.230.03



Art. T.230.03 - RF digital room SLIMTRON type chronothermostat, wireless and touchscreen, with radio-frequency control signals transmission to its appropriate receiver (see next item). Battery powered 2 x AA with daily and weekly temperature programming. Wall-mounted on a slim, beige box 111 x 82 x 23, in refined and elegant design. Maximum signal distance: 200 mt. in open space.

Compatible with single-channel RF receivers Art T.235 and multi-channel Art. T.241.08. Transmission frequency: 433 MHz. Allows for the programming of different room temperatures every day of the week, 24h. Wide touchscreen backlit LCD display. With antifreeze function and programming stop.

R.F. receiver



Art. T.235.00



Art T.235 - 1-channel RF receiver with built-in antenna. Compatible with chronothermostat T.230.03. Maximum signal distance: 200 mt. in open space.

Power: 230 VAC. Outlets: control 3A. Pumpswitch 3A. Paired with thermostat art. T.230.03 can control a boiler, a motorised valve, an actuator or any other electrical appliance. Can be used as an additional channel receiver on 8-channels receiver (art. T.241.08) to increase the total amount of receivers needed for the system. Suitable for connection to an external temperature probe - optional art. T.223 or K.360 - for underfloor heating systems to limit and control with selected range the maximum temperature on the flow pipe.



Multi-channel R.F. receiver for wireless thermostats and chronothermostats



Art. T.241.08

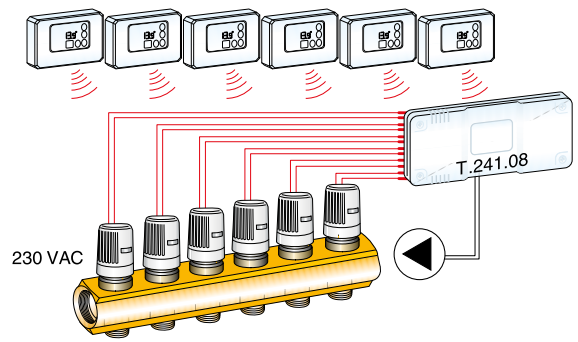

Art. T.241.08 – Multichannel RF receiver for wireless thermostats T.230.03 signals in plastic boxes with connections for manifold's electrical actuators and with electronic circuit consent for the circulating pump and the boiler. To install next to the manifold, considering that the RF signal reception capacity is within 200 mts open space. The circuit provides an outlet for the pump's (and boiler's) switching on and off when one or more thermostats require heating.

You can combine up to 4 actuators together on the same outlets. RF signal reception: 200 mt open space – Inlet voltage: 230 Vac – Actuators outlet voltage: 230 Vac. Pump outlet voltage: 230 Vac AA. Frequency: 433 MHz. – Compatible with models T.230.03. Note: for more than 8 channels, add an additional receiver for each channel, Art. T.235.



Note: set the quantity of RF receiving channels in accordance with the quantity of room thermostats (transmitters).

Consider that the signal reception signal in R.F. is 200 mt in open spaces, so, because of the obstructions, a distance of 150 mts is to be considered (the distance may vary).

CONNECTING OPTIONS:

- **9 wireless thermostats:** 1 multi-channel receiver with 8-channels Art. T.241.08 + 1 single-channel receiver Art. T.235
- **11 wireless thermostats:** 1 multi-channel receiver with 8-channels Art. T.241.08 + 3 single-channel receivers Art T.235
- **12 wireless thermostats:** 2 multi-channel receivers with 8 channels (4 remain free)

Art. T.230.03

Art. T.241.08

N° 2 Art. T.235



Manifold with zone valves

Electrical connection boxes

For wired thermostats and chronothermostats



Art. T.239

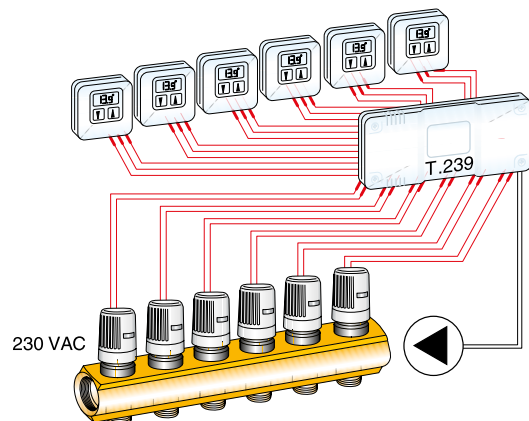

Art. T.239 – Plastic box for electrical connections of wired thermostats and electric actuators (Art. V.058), with electronic circuit di consenso for circulating pump and boiler. In order to achieve this, the wires of all thermostats (or chronothermostats), of the actuators and the pump, must be assembled in the box, to be installed near the manifold. The inner electrical circuit provides an outlet for the circulating pump's switching on and off when one or more thermostats require heating.

You can combine up to 4 actuators on the same outlet – Inlet voltage: 230 VAC – Actuators' outlet voltage: 230 VAC - Pump outlet voltage: 230 VAC 4 A.

| N° of areas | Item code | Dimensions mm |
|-------------|-----------|----------------|
| 8 | T.239.08 | 310 x 110 x 58 |
| 12 | T.239.12 | 310 x 110 x 58 |

Embedded boxes and adjustment plates for thermostats



Art. T.450.60

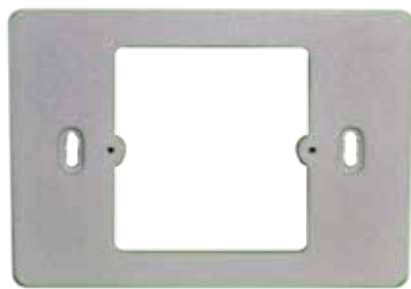

Art. T.453

Art. T.450.60 – Embedded box 72 x 72 x 50 type 502, wall-fixing with screws and distance 60.

Suitable for embedded thermostats.

Art. 453 – Adjustment plate for embedded box 502 E (dimensions 72 x 72 depth 50) with embedded boxes defined below.

| Item code | From type 502 E to type |
|-----------|-------------------------|
| T.440.23 | 503 |
| T.440.53 | 504 |

Thermostats and chronothermostats for towel warmers



Art. G.686

Example of pipework alteration for subsequent insertion of the resistance in current systems.

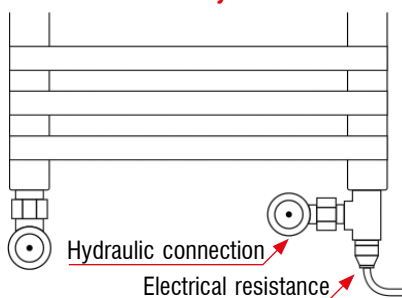

Art. G.686 – Complete kit for equipping towel warmers with electrical functioning. Complete with fitting with outlet 1/2" F. and electrical resistance, with power supply cable (Art. G.680) – Tension 230 V – Protection level IP 44.

Electrical resistances can also be controlled by a wall-mounted room thermostat.

Protection level IP44 – It is absolutely forbidden to install an electrical resistance with higher power (Watt) than that produced by the hot-water radiator.

| Item code | Power W | Joint colour |
|-----------|---------|----------------|
| G.686.30 | 300 | White Ral 9010 |
| G.686.31 | 300 | Chrome |
| G.686.40 | 400 | White Ral 9010 |
| G.686.41 | 400 | Chrome |
| G.686.60 | 600 | White Ral 9010 |
| G.686.61 | 600 | Chrome |



Art. T.501



Art. T.501 – Electronic analogic room thermostat "Thesis Plus" for electrical towel warmers control, installable on the electrical resistance. Through an external sensor, it maintains the desired room temperature. With "Boost" function, which activates the electrical resistance to its maximum power up to 2 hours. With functions: "Comfort", "Stand-by" and "Timer", with which the "Boost" function is repeated 1 or 2 times a day, at users requested.

Complete with electric cable – Adjustable temperature: 7°C – 32°C. Voltage: 230 V. – 50 Hz. – Protection level IP11 – Dimensions: 113 x 73 x 39 mm.

| Item code | Device colour | Cable colour |
|-----------|---------------|--------------|
| T.501.00 | White | White |
| T.501.01 | Chrome | Grey |



Art. T.502



Art. T.502 – Digital room chronothermostat "Musa Plus" for control of electric towel warmers; can be installed on electrical resistances, with wide backlit display. With external sensor, it maintains the desired room temperature, as programmed by the user. Includes functions: "Comfort", "Night-time reduction", "Anti-freeze", "Timer" and "Stand-by."

- "Comfort": maintains desired room temperature;
- "Night-time reduction": maintains a lower room temperature compared with "Comfort" temperature;
- "Anti-freeze": maintains temperature above 7°C;
- "Timer": activates the electrical resistance to the highest power for two hours; "Chrono" follows a daily plan, as set by the user, weekly, on repeat.;
- "Stand-by": the electrical resistance is de-activated but the appliance keeps functioning.

Complete with electric cable - Adjustable temperature: 7°C - 32° - Voltage: 230 V. - 50 Hz. - Protection: IP44 - Dimensions: 113 x 73 x 39 mm.

| Item code | Device colour | Cable colour |
|-----------|---------------|--------------|
| T.502.00 | White | White |
| T.502.01 | Chrome | Grey |

Analogic and digital encased thermostats

Contact thermostat



Art. T.017.05



Art. T.018.10

Art. T.017.05 – Contact thermostat with temperature control handle.

Temperature range: 0°C ÷ 90°C. Switch contacts 10°. Complete with fixing springs. Protection level IP 40.

Art. T.018.10 – Contact thermostat with inner temperature control.

Temperature range: 0°C ÷ 90°C. Switch contacts 10°. Complete with fixing springs. Protection level IP 40.



Art. T.019.70

Digital



Art. T.116.00

Art. T.019.70 – Safety contact thermostat with manual reset and inner temperature adjustment.

Temperature range: 40°C ÷ 70°C. Switch contacts 10°. Especially suited for underfloor heating systems. Complete with fixing springs. Protection level IP 40.

Art. T.116.00 – Electronic temperature with touchscreen display, with temperature display. Temperature control range: 5° - 80°C. With spring clamp.

Power: 230 Vac – Switches: ON-OFF – 10 A. With cold-hot inversion. Protection level: IP 40.

Immersion thermostat



Art. T.020.00



Art. T.021

Art. T.020.00 – Immersion thermostat with adjustment handle. Sheath length 100 mm. Range: 0°C ÷ 90°C.

Switch contacts 10 A. With immersion pocket. Protection level IP 40. Sheath connection 1/2".

Art. T.021 – Safety immersion thermostat with manual reset sheath.

Switch contacts 16 A. Sheath length 100 mm. Sheath connection 1/2" M.

| Item code | Control |
|-----------|---|
| T.021.00 | 100°C (fixed) |
| T.021.70 | 40° ÷ 70° C adjustable (also used for underfloor heating systems safety) |



Art. T.022.10

Digital



Art. T.115.00

Art. T.022.10 – Immersion thermostat with sheath and inner temperature control.

Temperature range: 0°C ÷ 90°C. Switch contacts 10 A. With immersion pocket. Protection level IP 40. Sheath connection 1/2". Sheath length 100 mm.

Art. T.115.00 – Electronic thermostat with display with immersion pocket 1/2" M, with temperature display. Temperature control range: 5° - 80°C.

Immersion pocket length: 50 mm – Power: 230 Vac. Switches: ON – OFF. 10 A – with cold-hot inversion – Protection level IP 40.

Double immersion thermostat



Art. T.025.10



Art. T.026.02

Art. T.025.00 – Double immersion thermostat with temperature control handle with immersion pocket and manual reset.

Adjustable thermostat range: $0^{\circ} \div 90^{\circ}\text{C}$. Fixed range for safety thermostat: 100°C – Switch contacts 10 A.

Art. T.026.02 – Double immersion thermostat with 2 adjustments sheath with knob.

Adjustable range: $0^{\circ}\text{C} \div 60^{\circ}\text{C}$ and $30^{\circ}\text{C} \div 120^{\circ}\text{C}$. Switch contacts. Sheath connection $\frac{1}{2}$ ", sheath length 100 mm.

For hot air generators



Art. T.151.28

Art. R.151.28 – Double thermostats for hot air generators with external temperature control knob.

Adjustable temperature range: LIMIT $30^{\circ}\text{C} \div 120^{\circ}\text{C}$. – FAN $0^{\circ}\text{C} \div 60^{\circ}\text{C}$. With drilled sheath and joint- Length 250 mm.

Capillary thermostats



Art. T.023



Art. T.024.10

Art. T.023 – Capillary thermostat with control knob.

Switch contacts. SPDT.

| Range °C | $-35^{\circ}\text{C} \div +35^{\circ}\text{C}$ | $0^{\circ}\text{C} \div +60^{\circ}\text{C}$ | $0^{\circ}\text{C} \div +90^{\circ}\text{C}$ |
|-------------------|--|--|--|
| Capillary length | 1.000 mm. | 1.500 mm. | 1.000 mm. |
| Bulb Ø and length | 6,5 x 100 | 6,5 x 100 | 6,5 x 100 |
| Item code | T.023.35 | T.023.60 | T.023.90 |

Art. T.024.10 – Capillary thermostat with manual reset.

Adjustable temperature range: $40^{\circ}\text{C} \div 70^{\circ}\text{C}$. Switch contacts. Capillary length mm. 1500. Diameter and bulb length mm. 6,6 x 73.

Digital thermostat with probe



Art. T.118.00



Art. T.123.00

Art. T.118.00 – Electronic thermostat with display and probe at a distance, and temperature display. Temperature control range: $5^{\circ} - 80^{\circ}\text{C}$.

Probe length: 1mt – Power: 230 Vac.

Switch: ON/OFF – 10 A – with cold-hot inversion – Protection level IP 40.

Art. T.123.00 – Digital thermostat with display and temperature display for panel mounting. Dimensions 77 x 35 mm (front) x 72 mm (depth). Complete with NTC 10K probe with length 2000 mm.

Resolution: $0,1^{\circ}\text{C}$. power supply 230 Vac/50Hz. Relay 16(4)A 240 Vac. Temperature range: $-40^{\circ}\text{C} \div 105^{\circ}\text{C}$.

Bimetal thermostat



Horizontal connections



R.198



Vertical connections



Art. R.198 – Safety microthermostat with golden contacts for boilers at fixed setting and rapid contact opening.

| | | | | | | | | |
|---------------------------------|-----------------------------|------------------------------|-----------------------------|------------------------------|----------------------------|----------------------|----------------------|----------------------|
| Intervention temperature | 130°C | 130°C | 120°C | 120°C | 120°C | 120°C | 110°C | 105°C |
| Faston terminal type connection | Horizontal thread M.3 x 0,5 | Horizontal 4,8 x 0,8 drilled | Horizontal thread M.3 x 0,5 | Horizontal 4,8 x 0,8 drilled | Horizontal 3 x 0,5 drilled | 6,3 Vertical drilled | 6,3 Vertical drilled | 6,3 Vertical drilled |
| Item code | R.198.30 | R.198.40 | R.198.20 | R.198.50 | R.198.21 | R.198.12 | R.198.10 | R.198.05 |
| Intervention temperature | 100°C | 95°C | 90°C | 85°C | 85°C | 80°C | 75°C | 63°C |
| Faston terminal type connection | 6,3 Vertical drilled | 6,3 Vertical drilled | Horizontal thread M.3 x 0,5 | Horizontal 4 drilled | 6,3 Vertical drilled | 6,3 Vertical drilled | 6,3 Vertical drilled | 6,3 Vertical drilled |
| Item code | R.198.00 | R.198.95 | R.198.90 | R.198.84 | R.198.85 | R.198.80 | R.198.75 | R.198.63 |



Art. T.030.06



Art. T.030.35
Art. T.030.40

Art. T.030 – Bimetal microthermostat complete with fixing spring and fixed setting - 10 A.

| Item code | Type | Setting |
|-----------|----------------------------|------------------------------|
| T.030.06 | Anti-freeze | Closes at 6°C - Open at 16°C |
| T.030.35 | Minimun temp. for fan-coil | Closes a 35°C |
| T.030.40 | Minimun temp. for fan-coil | Closes a 42°C |

For pellet stoves



Art. T.033

Art. T.033 – Bimetal screw microthermostat 4 mm. With fixed intervention temperature – 10 A.

| Item code | Contacts N.C. setting |
|-----------|-----------------------|
| T.033.00 | 100°C |
| T.033.10 | 110°C |
| T.033.20 | 120°C |

Temperature probes for thermostats and thermoregulators

Temperature probes



Art. T.223

Art. T.223 – Temperature probe normally used for underfloor heating systems, complete with 3 mt cable, can be connected to thermostats Art T.420, but can also be used to measure piping temperature and internal/external temperature.

Type NTC 25°C = 10K = Diameter 7 mm – Control range: -9.5°C / 99.5°C.

| Type | Soft cable | Rigid cable to be inserted in underfloor sheaths |
|-----------|------------|--|
| Item code | T.223.00 | T.223.03 |

Temperature probes for solar panels

Pt 1000



Art. T.210.00

Art. T.210.00 – Temperature probe for solar panels Pt 1000Cl.B EN60751.

Stainless hose sensor 6x50mm – Grey silicone hose length: 1000 mm – Ends with pre-insulated caps. Temperature range: +50/+180°C.

Art. T.224.00 – Temperature probe for solar panels pt 100.

Stainless hose sensor 6x50mm – Length 2000 mm. Temperature range: -30/+150°C.

Pt 100

NTC 47K



Art. T.224.00



Art. N.142.47

Art. N.142.47 – Air and water probe, waterproof, type NTC 47K with TPE cylindrical bulb 5 x 20mm.

Operating temperature: -40 °C/+110 °C. Capsule length: 20 mm. Diameter: 5 mm. Cable type: round with double TPE insulation – Length 1 mt.

Temperature and sensor probe for biomasses boilers and stoves

NTC temperature sensors

47K



Art. N.142.47

10K



Art. N.143.01

Art. N.142.47 – Air and water probe, waterproof type NTC 47K with TPE cylindrical bulb 5 x 20mm.

Operating temperature: $-50^{\circ}/+110^{\circ}\text{C}$. Capsule length: 20 mm.
Diameter: 5 mm. Cable type: round with double TPE insulation. Length 1 mt.

Art. N.143.01 – Air probe type NTC 10K epoxy in PVC.

Operating temperature: $-30^{\circ}\text{C}/+105^{\circ}\text{C}$. Capsule length: 5 mm.
Diameter: 3 mm. Cable type: PVC HT 105° - Length 1 mt.

10K



Art. N.145.02

10K



Art. N.146.04

Art. N.145.02 – Air probe type NTC 10K with TPE bulb 6 x 5 x 15 mm.

Operating temperature: $-50^{\circ}\text{C}/+110^{\circ}\text{C}$. Capsule length: 20 mm.
Diameter: 5 mm. Cable type: flat in TPE - Length: 1 mt.

Art. N.146.04 – Waterproof air probe type NTC 10K with cylindrical bulb in TPE 5 x 20 mm.

Operating temperature: $+50^{\circ}/+110^{\circ}\text{C}$. Capsule length: 20 mm.
Diameter: 5 mm. Cable type: round with double insulation in TPE. Length: 1 mt.

1K

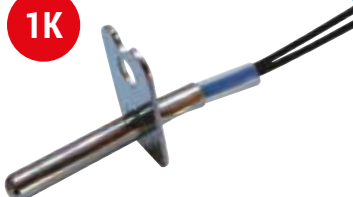

Art. N.147.01

1K

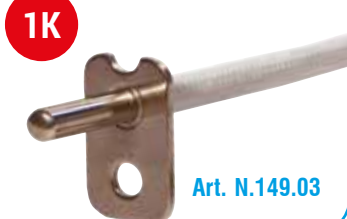

Art. N.149.03

Art. N.147.01 – Fume control probe type NTC 1K 300°C with fixing flange 20 + 20 mm.

Operating temperature: $0^{\circ}\text{C}/+300^{\circ}\text{C}$. Capsule length: 40 mm.
Diameter: 4 mm. Cable type: Teflon - Length 200 mm.

Art. N.149.03 – Fume control probe type NTC 1K 300 °c with fixing flange 11 mm and protection sheath, with steel bulb.

Operating temperature: $0^{\circ}\text{C}/+300^{\circ}\text{C}$. Capsule length: 11 mm.
Diameter: 4 mm. Length: 1 mt.

Temperature thermocouple

J



Art. N.150

J



Art. N.153

Art. N.150 – Temperature thermocouple type “J” with steel hose and “Vetrotex” cable.

Operating temperature: $0^{\circ}/+350^{\circ}\text{C}$.

| Item code | Ø mm. | Length mm |
|-----------|--------|-----------|
| N.150.01 | 4 X 30 | 880 |
| N.150.02 | 4 X 30 | 1.250 |
| N.150.04 | 4 X 40 | 880 |
| N.150.05 | 4 X 40 | 1.250 |

Art. 153 – Temperature thermocouple type “J” with steel hose and “Vetrotex” cable, with fixing flange 23 + 17 mm.

Operating temperature: $0^{\circ}/+350^{\circ}\text{C}$.

| Item code | Ø mm. | Length mm |
|-----------|--------|-----------|
| N.153.01 | 4 X 40 | 880 |
| N.153.02 | 4 X 40 | 1.250 |

Art. 155.00 – Thermocouple for fume control type “K” 550 °C.

Operating temperature: $0^{\circ}/+550^{\circ}\text{C}$. Capsule: 6 x 60.
Capsule length: 60 mm. Diameter: 6 mm.
Cable type: glass fiber. Cable length: 3 mt.

K



Art. N.155.00

K



Art. N.157.00

Art. 157.00 – Thermocouple for fume control type “K” 400°C with fixing flange 20 + 20 mm.

Operating temperature $0^{\circ}/+400^{\circ}\text{C}$. Capsule: 4 x 40.
Capsule length: 40 mm. Diameter: 4 mm.
Cable type: glass fiber. Cable length: 1,10 mt.

K



Art. N.159.00

Art. N.159.00 – Thermocouple for fume control type “K” 900°C.

Operating temperature: $0^{\circ}/900^{\circ}\text{C}$. Capsule: 3 x 110.
Capsule length: 110 mm. Diameter: 3 mm.
Cable type: silicone. Cable length: 2 mt.

Immersion pockets for thermostats and temperature probes



Art. R.140

Art. R.140 – Immersion pockets for thermostats, thermometers and temperature probes

| Item code | Connections | Internal Ø mm | Length | Item code | Connections | Internal Ø mm | Length |
|-----------|-------------|---------------|--------|-----------|-------------|---------------|--------|
| R.140.00 | 3/8"M. | 9 | 30 | R.140.50 | 1/2"M. | 9 | 50 |
| R.140.87 | 3/8"M. | 7 | 70 | R.140.03 | 1/2"M. | 9,75 | 60 |
| R.140.80 | 3/8"M. | 10 | 100 | R.140.05 | 1/2"M. | 9 | 150 |
| R.140.01 | 1/2"M. | 7 | 50 | R.140.06 | 1/2"M. | 9 | 190 |
| R.140.02 | 1/2"M. | 7 | 120 | R.140.07 | 1/2"M. | 9 | 280 |
| R.140.15 | 1/2"M. | 7 | 150 | R.140.04 | 1/2"M. | 9 | 90 |
| R.140.22 | 1/2"M. | 7 | 200 | R.140.20 | 1/2"M. | 14 | 200 |
| R.140.25 | 1/2"M. | 7 | 250 | R.140.33 | 1/2"M. | 14 | 300 |
| R.140.30 | 1/2"M. | 7 | 300 | R.140.08 | 1/2"M. | 14 | 100 |
| R.140.35 | 1/2"M. | 7 | 350 | R.140.09 | 1/2"M. | 14 | 120 |
| R.140.40 | 1/2"M. | 7 | 400 | R.140.10 | 1/2"M. | 14 | 150 |
| R.140.45 | 1/2"M. | 7 | 450 | | | | |

For solar panels

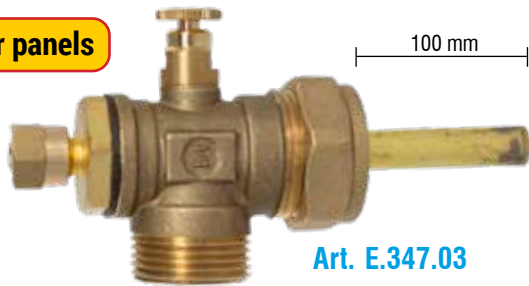

Art. E.347.03

Art. E.347.03 – Cross fitting with probe holder and manual vent-valve.

SQ connections 3/4"M. x Ø 22 mm – Suitable for solar panels.

Art. R.141.02 – Pack of 20 friction springs for immersion pockets. Length 100 mm. Diameter for 15 mm hole.



Art. R.141.02

Art. R.142.02 – Pack of 10 steel spring for fastening of thermostats capillary.



Art. R.142.02

Art. R.143 – Brass probe holder immersion pocket 1/2"M. with plastic cable gland for cables Ø 6-8 mm.

Inner diameter: 9 mm.

| Item code | Length L |
|-----------|----------|
| R.143.30 | 30 mm. |
| R.143.50 | 50 mm. |



Art. R.143



Art. R.144

Art. R.144 – Probe holder immersion pocket with fixing compression fitting capsule Ø 8 mm- With plastic cable gland for cables Ø 6 – 8 mm.

| Item code | Diameter |
|-----------|----------|
| R.144.18 | 1/8" |
| R.144.04 | 1/4" |

Mounting spring for cable probes



Art. R.147.18

Art. R.147.18 – Pack of 10 fastening springs for probes of boiler's piping Ø 18.

Consisting of a sheet metal collar in galvanized harmonic steel.

Floor panel with absorber



Art. R.148.10

Art. R.148.10 – Floor heat absorber immersion pocket, copper, 90 x 90 for easy insertion and extraction of probe with rigid cable in case of replacement. Complete with guide shell and 90° curved locking device art. G.737.16.

The pocket consists of a brass sheath welded to the copper body with threaded ends 1/2" M. that can be connected to a copper, polyethylene and multilayer pipe to protect the cable from the pit to the thermostat and to allow easy removal and re-insertion of the probe in case of replacement.

4-way mixing valves



Art. E.140

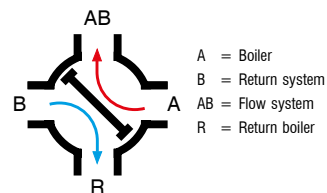

Art. E.140 – 4-way mixing valve cross-type threaded complete with servo motor opening and closing.

Power supply: servomotor 230 Vac.

| Without servomotor | | With servomotor | |
|--------------------|----------|-----------------|----------|
| Item code | Diameter | Item code | Diameter |
| E.140.03 | 3/4" | E.140.53 | 3/4" |
| E.140.10 | 1" | E.140.60 | 1" |
| E.140.14 | 1 1/4" | E.140.64 | 1 1/4" |
| E.140.12 | 1 1/2" | E.140.62 | 1 1/2" |
| E.140.20 | 2" | E.140.70 | 2" |



Art. E.142

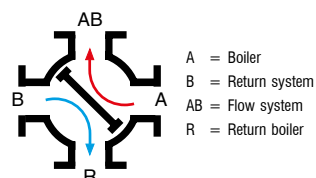

Art. E.142 – 4-way cast iron mixing valve cross-type flanged serie. Heavy type.

| Without servomotor | | | |
|---------------------------|-----------|--------------|-----------|
| Diameter Ø | 2" DN 50 | 2 1/2" DN 65 | 3" DN 80 |
| Item code | E. 142.20 | E. 142.22 | E. 142.30 |
| With servomotor T.109.00. | | | |
| Diameter Ø | 2" DN 50 | 2 1/2" DN 65 | 3" DN 80 |
| Item code | E. 142.70 | E. 142.72 | E. 142.80 |



Art. E.614

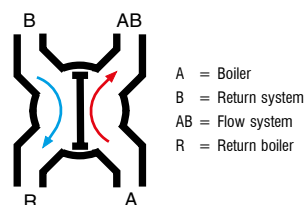

Art. E.614 – 4-way cast iron mixing valve cross-type with parallel connections 1 1/2" M. x 1 1/2" F. swivel.

Can be installed with boiler connections below and systems connections above.

| Model | Without servomotor | With servomotor T.109.00 |
|-----------|--------------------|--------------------------|
| Item code | E. 614.12 | E. 614.14 |

3-way mixing valves



Art. E.141



Models

Butterfly Type

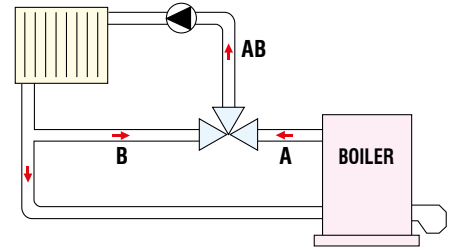
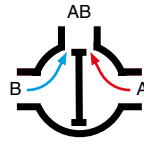

Sector Type

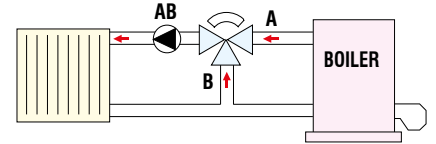
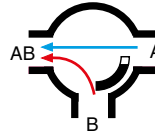

A = Boiler B=Return system AB=Flow system

Art. E.141 - 3-way threaded mixing valve. Connections F – brass from 3/4" to 1 1/4" with distance 72. Cast-iron from 1 1/2" to 2".

| Model | Butterfly Type | | | | | | Model | Sector Type | | | | |
|-----------------|--------------------|------------|-----------|-----------|-----------|-----------|-----------------|-------------|--------------------|------------|-----------|-----------|
| | Without servomotor | Diameter Ø | 3/4" | 1" | 1 1/4" | 1 1/2" | | 2" | Without servomotor | Diameter Ø | 1" | 1 1/4" |
| | Item code | E. 141.03 | E. 141.10 | E. 141.14 | E. 141.12 | E. 141.20 | | Item code | E. 141.11 | E. 141.15 | E. 141.13 | E. 141.21 |
| With servomotor | Diameter Ø | 3/4" | 1" | 1 1/4" | 1 1/2" | 2" | With servomotor | Diameter Ø | 1" | 1 1/4" | 1 1/2" | 2" |
| | Item code | E. 141.53 | E. 141.60 | E. 141.64 | E. 141.62 | E. 141.70 | | Item code | E. 141.61 | E. 141.65 | E. 141.63 | E. 141.71 |



Art. E.144



Models

Butterfly Type

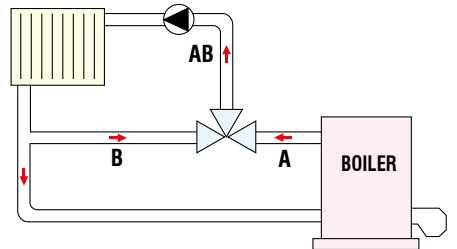
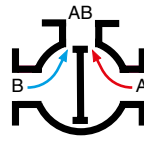

Sector Type

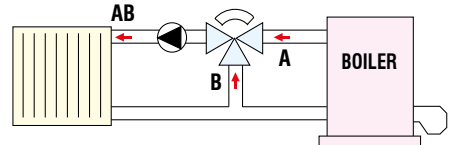
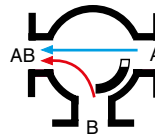

A = Boiler B=Return system AB=Flow system

Art. E.144 - 3-way cast iron flanged mixing valve.

| Model | Butterfly Type | | | | | Model | Sector Type | | | | |
|-----------------|--------------------|------------|--------------|--------------|-----------|-----------------|-------------|--------------------|--------------|----------|--------------|
| | Without servomotor | Diameter Ø | 2" DN 50 | 2 1/2" DN 65 | 3" DN 80 | | 4" DN 100 | Without servomotor | Diameter Ø | 2" DN 50 | 2 1/2" DN 65 |
| | Item code | E.144.20 | E.144.22 | E.144.30 | E.144.40 | | Item code | E.144.21 | E.144.23 | E.144.31 | E.144.41 |
| With servomotor | Diameter Ø | 2" DN 50 | 2 1/2" DN 65 | 3" DN 80 | 4" DN 100 | With servomotor | Diameter Ø | 2" DN 50 | 2 1/2" DN 65 | 3" DN 80 | 4" DN 100 |
| | Item code | E.144.70 | E.144.72 | E.144.80 | E.144.90 | | Item code | E.144.71 | E.144.73 | E.144.81 | E.144.91 |

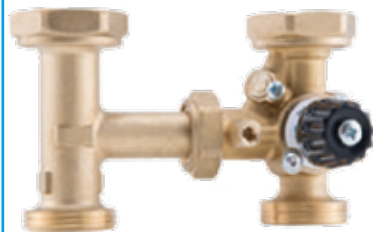

Art. E.143.2-



Art. E.143.1-

Art. E.143 - 3-way brass mixing valve with by-pass with pump connections F. swivel

| | | |
|-----------|--|---|
| Size: | DN 25 | |
| Type | With aligned connection fitting 1 1/2" M. x 1 1/2" F. swiv. (Art. E.609.20) with bypass | Only valve Kv10 1 1/2" M. x 1 1/2" F. swiv. x 1" M. with bypass |
| Item code | E.143.22 | E.143.12 |
| Size: | DN 32 | |
| Type | With aligned connection fitting 2" M. x 2" F. swiv. (Art. E.609.20) | Only valve Kv18 2" M. x 2" F. swiv. x 1 1/4" M. |
| Item code | E.143.23 | E.143.13 |

Servomotors for mixing valve



Art. T.106



With thermoregulator

Art. T.107.00

Art. T.108.01

For valve:
E.140.03
E.140.10
E.140.14
E.141.11
E.141.15
E.143.12
E.614.12



Art. T.108.02

For valve:
E.140.12
E.141.03
E.141.10
E.141.12
E.141.13
E.141.14



For valves with Ø up to 4"



Art. T.109.00



Art. T.109.40

Art. T.106 – Bidirectional servomotor for mixing valves. Pair: 10 Nm – Power 230 Vac. Opening and closing time: 90".

Of adequate power for valves with diameter up to 1 1/2". Rotation angle: 90°. For valve coupling joints see art. T.108.xx below.

| Item code | Model |
|-----------|--|
| T.106.00 | Opening and closing |
| T.106.10 | Modulating: 10 V. or 4-20 mA with output |

Art. T.107.00 - Bidirectional servomotor for mixing valves, complete with modulating thermoregulator for fixed point temperature regulation. Complete with display with two buttons and temperature probe. Adjustment range: 01-100° C. Pair 10 Nm - Power supply 230 Vac - Opening-closing time: adjustable 60-150". Parameterizable opening and closing direction - Parameterizable heating or cooling mode.

Of adequate power for valves with diameters up to 1 1/2". Rotation angle: 90°. For valve coupling joints see art. T.108.xx below.

Art. T.108 – Servomotor coupling joint art. T.106.xx and T.107.00 with mixing valves.

| Item code | Type for valves |
|-----------|--|
| T.108.01 | E.140.03 - E.140.10 - E.140.14 - E.141.11 E.141.15 E.143.12 - E.614.12 |
| T.108.02 | E.140.12 - E.141.03 - E.141.10 - E.141.12 E.141.13 - E.141.14 |

Art. T.109.00 - Bidirectional servomotor for mixing valves with limit microswitch - 22 Nm - Opening or closing time: 120 " - 230 V. Suitable power for valves up to 4" - DN 100.

See chart on the left for the coupling joint to the valve.

Coupling joints servomotor T.109.XX

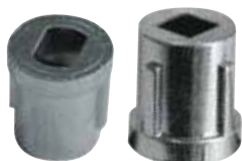

Art. T.200

Reference drawings

E.140.03 • E.140.10
E.140.14 • E.140.12
E.141.03 • E.141.10
E.141.14 • E.141.12
MUT & HONEYWELL

E.614.12 • HONEYWELL
TERMO-MIX • E.S.B.E. - I.M.T.
ELESTA • TERMOSTATICA 22
BUCHE • VILB 62"
MUT new type

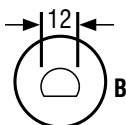
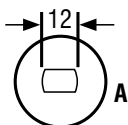

Art. cod T.200.33 Art. cod T.200.37

Art. T.109.40 - Bidirectional servomotor for mixing valves with limit microswitch - 22 Nm - Opening or closing time: 120 " - 230 V. Suitable power for valves up to 4" - DN 100. With moving bracket to allow installation on valves with insulation or where coupling with offset valve is necessary. Offset mm: 40. Necessary for installation on valves Art.E.142.70 and Art.E.142.72.

Complete with valve joint: Art. E.140 and Art.E.141.

Art. T.200 – Coupling for servomotors to mixing valves Art. T.109.

| Item code | Reference |
|-----------|-----------|
| T.200.33 | A |
| T.200.37 | B |

Motorised valves and zone-valves



Art. T.080

Art. T.080 - Brass motorised zone-valve "HOTWELL." 230 V – 50 Hz.

Normally closed, in absence of voltage it goes back to closure. With lever for manual opening.

| Item code | Type | Connections | Kv |
|-----------|-------|-----------------------------|-----|
| T.080.03 | 2-WAY | 3/4" F. x 3/4" F. | 5,7 |
| T.080.00 | 2-WAY | 1" F. x 1" F. | 8,7 |
| T.080.13 | 2-WAY | 3/4" M. x 3/4" M. | 5,7 |
| T.080.10 | 2-WAY | 1" M. x 1" M. | 8,7 |
| T.080.22 | 2-WAY | Copper Pipe Ø 22 | 5,7 |
| T.080.28 | 2-WAY | Copper Pipe Ø 28 | 8,7 |
| T.080.33 | 3-WAY | 3/4" F. x 3/4" F. x 3/4" F. | 5,5 |
| T.080.30 | 3-WAY | 1" F. x 1" F. x 1" F. | 8,3 |
| T.080.43 | 3-WAY | 3/4" M. x 3/4" M. x 3/4" M. | 5,5 |
| T.080.40 | 3-WAY | 1" M. x 1" M. x 1" M. | 8,3 |
| T.080.42 | 3-WAY | Copper Pipe Ø 22 | 5,5 |
| T.080.48 | 3-WAY | Copper Pipe Ø 28 | 8,3 |

Art. T.098 - 2- or 3-way motorised ball valve with coplanar connections.

With brass ball valve and drive servomotor.

Power: 230 Vac, protection level IP54.

Connections M.

| Type | 2 way | | | |
|-----------|-----------------|----|------------------|--------------|
| Item code | Connections | DN | Max. Press. Bar. | Opening time |
| T.098.03 | 3/4" x 3/4" | 20 | 25 | 45" |
| T.098.10 | 1" x 1" | 25 | 10 | 90" |
| T.098.14 | 1 1/4" x 1 1/4" | 32 | 10 | 90" |
| T.098.42 | 1 1/2" x 1 1/2" | 40 | 10 | 90" |
| T.098.40 | 2" x 2" | 50 | 10 | 90" |

| Type | 3 way | | | |
|-----------|--------------------------|----|-----------------|--------------|
| Item code | Connections | DN | Max. Press.Bar. | Opening time |
| T.098.53 | 3/4" x 3/4" x 3/4" | 20 | 25 | 45" |
| T.098.50 | 1" x 1" x 1" | 25 | 10 | 90" |
| T.098.54 | 1 1/4" x 1 1/4" x 1 1/4" | 25 | 10 | 90" |
| T.098.52 | 1 1/2" x 1 1/2" x 1 1/2" | 32 | 10 | 90" |



Art. T.098

Art. T.102 – Straight through passage motorised ball valve.

Power supply: 230 V. – 50 Hz. with limit microswitch 5A – Operating pressure 10 bar – Protection level IP40.

| 2-WAY SHUT-OFF VALVES | | | 3-WAY DIVERTER VALVE | | |
|-----------------------|-----------------------|--------------|----------------------|-----------------------------------|--------------|
| Item code | Diameter Ø | Running time | Item code | Diameter Ø | Running time |
| T.102.03 | 3/4" M. x 3/4" M. | 60 seconds | T.102.53 | 3/4" M. x 3/4" M. x 3/4" M. | 60 seconds |
| T.102.10 | 1" M. x 1" M. | 60 seconds | T.102.50 | 1" M. x 1" M. x 1" M. | 60 seconds |
| T.102.14 | 1 1/4" M. x 1 1/4" M. | 60 seconds | T.102.54 | 1 1/4" M. x 1 1/4" M. x 1 1/4" M. | 60 seconds |
| T.102.42 | 1 1/2" M. x 1 1/2" M. | 60 seconds | T.102.52 | 1 1/2" M. x 1 1/2" M. x 1 1/2" M. | 60 seconds |
| T.102.40 | 2" M x 2" M. | 120 seconds | | | |



Art. T.102

Valves plus actuators



Art. T.137

Art. T.137 – 2-way linear valve with stainless steel closing shaft with vertical intake 4 mm – Actuator connection 30x1,5.

Can be combined with thermostatic actuators Art.T.130.70.

Can be combined with electrical actuators Art. V.058.

| | | | | |
|-------------|-----------------|-----------------|-------------|-------------|
| Connections | 3/4”M. x 3/4”M. | 3/4”F. x 3/4”F. | 1”M. x 1”M. | 1”F. x 1”F. |
| Ksv | 2,8 | 2,8 | 4,5 | 4,5 |
| Item code | T.137.03 | T.137.30 | T.137.10 | T.137.00 |



Art. T.138

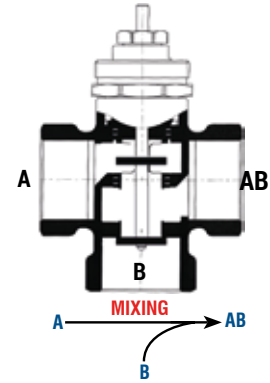
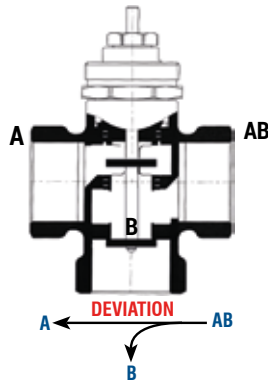

Art. T.138 – 3-way (A x B x AB) linear valve with stainless steel closing shaft with vertical intake 4 mm – Actuator connection 30 x 1,5.

Can be combined with thermostatic actuators Art.T.130.70.

Can be combined with electrical actuators Art. V.058.



Art. V.058

Art. V.058 - N.C. electrothermic actuator for electronic opening and closing of the valves of the manufacturers listed below.

Can be controlled by room thermostat to individually control areas temperature.

| Model | Item code | Valve manufacturers | Connections | Voltage Volts |
|---------------------------|-----------|---|-------------|---------------|
| Without limit microswitch | V.058.01 | Antares, Honeywell, MNG, Heimeir, Watts | M.30 x 1,5 | 230V AC |
| | V.058.02 | Antares, Honeywell, MNG, Heimeir, Watts | M.30 x 1,5 | 24V AC |
| With limit microswitch | V.058.35 | Antares, Honeywell, MNG, Heimeir, Watts | M.30 x 1,5 | 230V AC |
| | V.058.36 | Antares, Honeywell, MNG, Heimeir, Watts | M.30 x 1,5 | 24V AC |



Art. T.130.70

Art. T.130.70 – N.C. thermostatic actuator remote controlled with bulb and capillary length 2000 mm with ABS knob. Control range: 20°C – 60°C. Bulb Ø 9, length 135 mm. Connection 30x1,5.

Normally closed. Can be installed on valves Art. V.051, V.052, V.053, V.054, T.137, T.138.

Possible application for temperature control

Radiant systems



Hot water in boilers

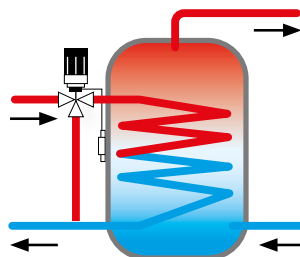

Air in fan heaters.

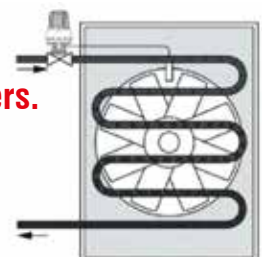



Art. T.142

Art. T.142 – 2-way brass valve, complete with electro-mechanical actuator (Art.V.058) with limit microswitch. Operating temperature max 110°C.

| Item code | Diameter | Ksv | Voltage |
|-----------|-------------------|-----|---------|
| T.142.05 | 3/4" M. x 3/4" M. | 2,8 | 24 V. |
| T.142.15 | 3/4" M. x 3/4" M. | 2,8 | 230 V. |
| T.142.10 | 1" M. x 1" M. | 4,5 | 24 V. |
| T.142.50 | 1" M. x 1" M. | 4,5 | 230 V. |



Art. T.143

Art. T.143 – 3-way brass valve, complete with electro-mechanical actuator (Art.V.058) with limit microswitch. Operating temperature max. 110 °C.

| Item code | Diameter | Ksv | Voltage |
|-----------|-------------------|-----|---------|
| T.143.05 | 3/4" M. x 3/4" M. | 2,8 | 24 V |
| T.143.15 | 3/4" M. x 3/4" M. | 2,8 | 230 V |
| T.143.10 | 1" M. x 1" M. | 4,5 | 24 V |
| T.143.50 | 1" M. x 1" M. | 4,5 | 230 V |

Electronic control units for thermo-fireplaces



Art. T.126.00

Art. T.126.00 – Electronic control unit for water temperature control in thermo-fireplaces.

Detects the temperature with a probe and controls the circulating pump. Sound alarm for temperatures over 90°C that also works if in OFF position. GRILL switch. Anti-freeze protection with automatic start-up of the pump. Comes with cover and probe. Supply: 230V ~ 15% 50 Hz. 60 Hz. Contacts 5A - 250 V ~ Temperature control: 30° ÷ 90°C. Intervention differential ~ 1.5°C. Probe type NTC. Temperature display: 20°C ÷ 90°C. Protection level IP30. With plastic casing for wall-fitting, 3 modules.



Art. T.128.00

Art. T.128.00 – Electronic digital control unit "201 RLX" for the control and adjustment of fireplace boilers, even combined with gas boilers with circuit separation, with heat exchangers, DHW storage and so on. Equipped with various system configurations, with various operating programmes you can select on a menu, through which you can adapt the control unit to the various systems available, with probe and 3-modules embedded box type 503.

Detects water temperature and control the circulator's switching on and off, and the automatic exclusion from the heating system to help domestic hot water supply with connection to the flowmeter. With anti-freeze function and automatic starting of circulator(s) to prevent the piping from freezing. 230 Vac.



Art. T.134.00

Art. T.134.00 – Electronic control unit AIR RLX for hot air thermo-fireplaces control. Complete with probe and 4-modules embedded box type 504.

Allows to display the temperature of the hot air outlet duct and to activate the vent once the set temperature is reached. 230 Vac.

Temperature thermo-regulators



Art. T.095.12



Art. T.095.12 – Modulating thermoregulator integrated in servomotor. Complete with 3-way brass mixing valve and temperature probe. Mixing valve with bypass and pump coupling. Control range: 1° - 100°C. Adjustable opening and closing time: 60 – 150°C. Parametrisable opening and closing flow – Parametrisable heating or cooling mode.

Power: 230 Vac – Kv Coefficient 10.

Connections: 1 1/2 F. swivel (circulator) x 1 1/2" M. x 1"

Suitable for:

- *Temperature reduction and control in underfloor radiant systems..*
- *Temperature control to avoid condensation in biomasses fueled systems.*
- *Temperature control in domestic hot water storage or distribution.*

Art T.096 – Modulating thermoregulator integrated im servomotor installed on (included) mixing valve and complete with temperature probe. Control range: 1°-100°C. Adjustable opening and losing time 60-150". Parametrisable opening and closing flow – Parametrisable heating or cooling mode.

Suitable for:

- *Temperature reduction and control in underfloor radiant systems..*
- *Temperature control to avoid condensation in biomasses fueled systems.*
- *Temperature control in domestic hot water storage or distribution.*



Art. T.096



| Item code | Type | Ø | Material |
|-----------|-------|--------|-----------|
| T.096.03 | 3 way | 3/4" | Brass |
| T.096.10 | 3 way | 1" | Brass |
| T.096.14 | 3 way | 1 1/4" | Cast-iron |
| T.096.12 | 3 way | 1 1/2" | Cast-iron |
| T.096.53 | 4 way | 3/4" | Brass |
| T.096.50 | 4 way | 1" | Brass |
| T.096.54 | 4 way | 1 1/4" | Brass |
| T.096.52 | 4 way | 1 1/2" | Cast-iron |



Art. T.101.07



Art. T.101.07 – Electronic room temperature control unit model T. Reg. 300, proportional integral with mixing valve control or burner, in relation to the external temperature variations, or in relation to room temperature daily and weekly programming.

It is an electronic device of advanced design which allows to keep under precise control the surrounding environment temperature. This control unit acquires temperature data from the probes and adapts the heating fluid to the desired temperature needs, for greater comfort.

The control unit programming is extremely easy: you just need to follow the instructions, setting them on the display.

This model T. Reg. 300 is a versatile device, which allows the user to choose its operating mode by connecting it to both mixing valves (integral proportional functioning) and burners (ON-OFF functioning).

These technical features make the installation of the control unit especially suited for civil and industrial systems heating.

Constant display of all the elements of the system: backlit graphic display. Dimensions: 158 x 90 x 58. Installation on Omega EN50092 rail (12 modules). With navigation control for probe temperature constant setting and control. Constant display of all the heating system temperatures. Setting languages: english, italian, spanish and french.



Art. T.124.00

Art. T.124.00 – Differential thermostat “Sundigit” for solar panels, wall-mounted with digital display, with 3 temperature probes.

When the panels temperature is higher than the temperature of the boiler’s water, the thermostat starts the pump, allowing heat exchange between panel and boiler. With clock display, as well as manifold and heater’s temperature. Manifold: 0°C – 200°C. Heater: 0°-100°C. Power: 230 Vac. Exit connections for pump and boiler: 5 A. Dimensions: 131 x 88 x (H) 27,2. Probes can be connected up to 100 mt.



Art. T.125.02

Art. T.125.02 – Differential thermostat SOLAR CONTROL for solar panels, with 3 probes – Installation on DIN rail for 3 modules.

When the panels temperature is higher than the temperature of the boiler’s water, the thermostat starts the pump, allowing heat exchange between panel and boiler. To ensure a perfect exchange, the device is equipped with a temperature differential “delta T”, variable from 1°C to 9°C, adjustable with the knob on the front of the thermostat.

Range: 30°-80°C. Differential range: 1-9°C. Power: 230 V. Relays outlet 10 A. Dimensions 53x90x58. Probes can be connected up to 100 mt. Equipped with 2 esclusio switches: solar panel pump, integration pump.



Art. T.127.04

Art. T.127.04 – Electronic control unit “SOLAR CONTROL SC 200” with solar panel display, with four temperature probes.

When the panels temperature is higher than the temperature of the boiler’s water, the thermostat starts the pump, allowing heat exchange between panel and boiler. To ensure a perfect exchange, the device is equipped with a temperature differential “delta T”, variable from 3°C to 15°C, adjustable with the knob on the front of the thermostat. Allows for integration of both sanitary water and traditional heating system.

Configuration of 4 different solar thermal systems:

- 1° System Boiler Panel
- 2° System Boiler Panel + accumulation boiler with automatic temperature control
- 3° Integration system to heating system with automatic control
- 4° Integration system to pool system with automatic control.

Domestic water priority.

Power: 230 Vac. Temperature reading field: -20°C. 120°C.

Fastening: onto electric board on DIN rail. 9 modules. See T.105.14.

Thermostatic mixing valves

For domestic use



Art. C.051

Art. C.051 – Thermostatic mixer for domestic water distribution systems with max. temperature 85°C. Range: 30°C ÷ 65°C. Check valve can be incorporated through art. P.002. on page 145 (W).

| | | | |
|----------------------------|--------------------------|--------------------------|--------------------|
| Connections | 1/2" M x 1/2" M x 1/2" M | 3/4" M x 3/4" M x 3/4" M | 1" M x 1" M x 1" M |
| Item code | C.051.02 | C.051.03 | C.051.10 |
| Flow rate lt./min. a 3 bar | 29 | 36 | 74 |



Art. C.053.10

Art. C.053.10 – Thermostatic mixer for domestic water distribution systems, with extractable cartridge, filter and chrome plated knob with block switch. Connections 1" M. x 1" M. x 1" M.

Control range: 30°C ÷ 65°C. flow rate lt/min. 3 bar: 42

For floor heating systems



Art. E.147



Art. E.149

Art. E.147 – 4-way brass thermostatic mixing valve, adjustable 25-55°C with pump connections 1 1/2" F. Swivel – Flow KV 3,5.

Suitable for temperature control in underfloor radiant systems.

| | | |
|-----------|---|--|
| Type | With aligned connection fitting 1 1/2" M. x 1 1/2" F. swiv. 8Art. E.609.12) | Only valve 1 1/2" M. x 1 1/2" F: swiv. x 1" M. |
| Item code | E.147.22 | E.147.32 |

Art. E.149 – Thermostatic mixer for underfloor systems.

Chrome-plated and sanded brass body. Control range: 30° ÷ 65°C. Graded scale: 1 ÷ 5. Small size, can be installed directly before the distribution manifolds for temperature reduction in underfloor heating systems.

| | | | |
|------------------|--------------------|--------------------------------|--------------------------------|
| Connections Ø | 1" M x 1" M x 1" M | 1 1/4" M x 1 1/4" M x 1 1/4" M | 1 1/2" M x 1 1/2" M x 1 1/2" M |
| Flow rate lt./h. | 4.320 | 6.120 | 7.980 |
| Item code | E.149.92 | E.149.14 | E.149.12 |

Art. E.150 – "L"-shaped brass thermostatic mixer for underfloor systems and for constant temperature control with adjustable flow: 20° ÷ 45°.

Suitable for installations where the flow and return pipes are parallel.

| | | |
|-------------|---|--------------------|
| Model | A | B |
| Connections | A Mix: pump flange Hot water: 1 1/2" M. – Cold water 1" M. | 1" M x 1" M x 1" M |
| Item code | E.150.12 | E.150.10 |

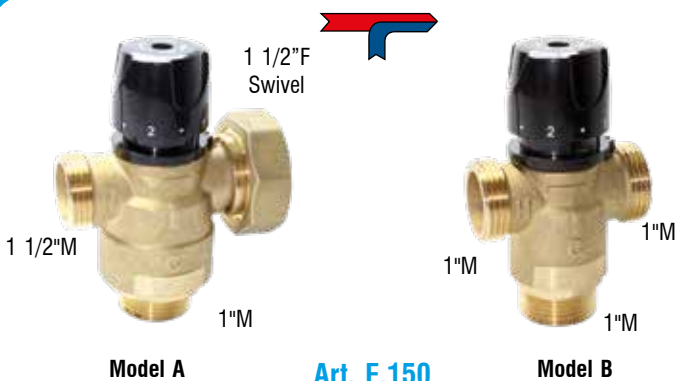

Art. E.150

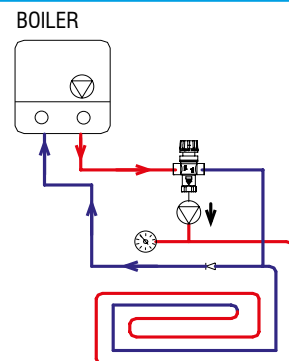
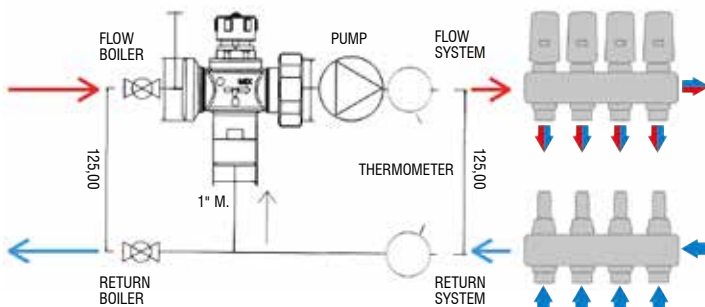

For solar thermal systems



Art. C.065



Art. C.067

Automatic switching valve C.067 in serie, of domestic water flow from solar panels burner to that of the boiler, when temperature is below 45°C.

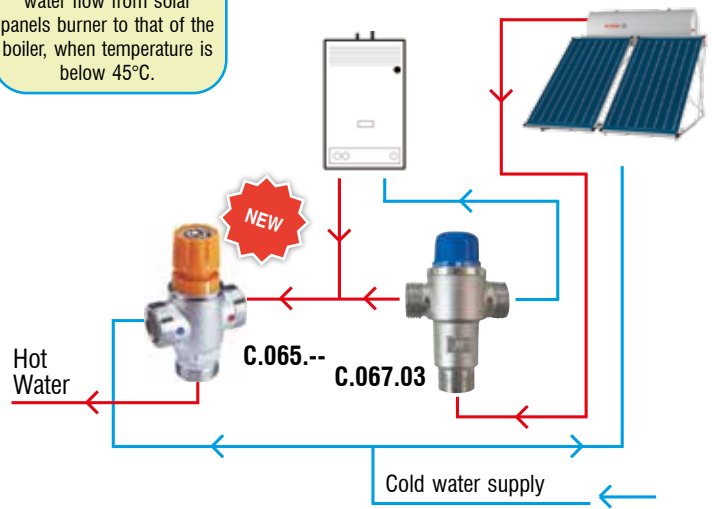

Art. C.065 – Thermostatic mixer for hot water distribution solar thermal systems with high temperatures up to 100°C. control range: 30°C – 65°C. With check-valve incorporated through art. P002.

Made for solar thermal systems with high temperatures, close to 100°C.

| Connections | 1/2" M x 1/2" M x 1/2" M | 3/4" M x 3/4" M x 3/4" M | 1" M x 1" M x 1" M |
|----------------|--------------------------|--------------------------|--------------------|
| Flow rate lt/h | 1.620 | 2.100 | 4.320 |
| Item code | C.065.02 | C.065.03 | C.065.10 |

Art. C.067 – Automatic thermostatic diverter valve of solar burner domestic water flow and boiler flow, when temperature is below 45°C..

Fixed calibration at 45°C – Max temperature 100°C.

| Connections | 3/4" M x 3/4" M x 3/4" M | 1" M x 1" M x 1" M |
|----------------|--------------------------|--------------------|
| Flow rate lt/h | 2.100 | 4.320 |
| Item code | C.067.03 | C.067.10 |



Art. C.069



Art. C.069 – Control kit for solar thermal system composed of diverter valve (Art. C.067) and mixing valve (Art. C.065). temperature control 30-65°C.

Made for solar thermal systems to deviate the fluid path according to the immediate temperature of it, and to give an appropriate usage control. Connections with 3 pieces M. fittings on the valves and outlet M. – Pre-calibrated diverter 45°C. Complete with insulating shell.

| Connections | 1/2" M | 3/4" M |
|----------------|----------|----------|
| Flow rate lt/h | 1.620 | 2.100 |
| Item code | C.069.02 | C.069.03 |

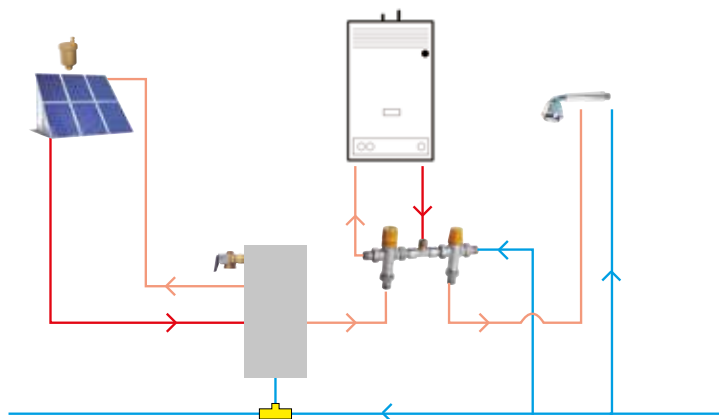



ANTARES in the World

Management Office:

- ▶ **Italy: LUCCA - Via degli Alpini, 144**
 - Tel. **+39 473701**
 - Mail: **ant3@antaresint.com**
 - WhatsApp: **+39 349 665 6433**
 - Website: **www.antaresint.com**

Manufacturing and distribution branches:

- ▶ **Italy: LUCCA - Via degli Alpini, 144**
- ▶ **Italy: LUCCA - Via Martini, 111**
- ▶ **Romania: BALDOVINESTI - via Propului,76**

Sales Departments:

Belgique

207, Av. Louise bte 4 - 1050 Bruxelles
Tél. (+32) 239 30 597 & WhatsApp. (+33) 423 24 3080
www.antaresint.com - be@antaresint.com

Deutschland

Feringastrasse 6 - 85774 Unterföhring
Tel. (+49) 899 394 8950 - WhatsApp. (+49) 01 762 097 7231
www.antaresint.com - de@antaresint.com

España

C/ Martinez Villergas, 49 - 28027 - Madrid
Teléfono & WhatsApp. (+34) 910 626 573
www.antaresint.com - es@antaresint.com

France

3 Cours Charlemagne - BP 2597 - 69217 Lyon Cedex 2
Téléphone & WhatsApp. (+33) 423 24 3080
www.antaresint.com - fr@antaresint.com

Ireland

Mespil House, Sussex Road, Dublin 4
Tel. (+353) 169 944 25 & WhatsApp. (+44) 1227 458 684
www.antaresint.com - eire@antaresint.com

Österreich

Landstrasser Hauptstrasse, 71/2 - 1030 Wien
Tel. (+49) 899 394 8950 - WhatsApp. (+49) 01 762 097 7231
www.antaresint.com - at@antaresint.com

Polska

Ul. Tomaszka Zana 39A 20-634 Lublin
Tel. 00 800 391 1223 **Infolinia bezpłatna**
www.antaresint.com - pl@antaresint.com

Portugal

Rua Castilho, n° 23-8° B - 1250 - 067 Lisboa
Tel. 800 83 90 42 **Número Verde**
www.antaresint.com - pt@antaresint.com

România

Str. Plopului, 76 - Com. Baldovinesti - 237005 JUD. OLT
Tel. (+40) 0786 325 646 - Mobil. (+40) 076 058 5909
www.antaresint.com - ro@antaresint.com

U.K.

35 Marine Terrace - Margate, Kent - CT9 1XJ
Telephone & WhatsApp. (+44) 1227 458 684
www.antaresint.com - uk@antaresint.com



PRE-SALE SUPPORT

Our technical office is always available for more detailed information, and to help you choose the right products.

- ▶ **Thermostats**
- ▶ **Thermoregulators**
- ▶ **Temperature probes**



- ▶ **Mixing valves**
- ▶ **Zone-valves**
- ▶ **Accessories**

ANTARES
for water & fire

Via degli Alpini, 144 - 55100 LUCCA - ITALY
Tel. +39 0583 473701
ant3@antaresint.com • www.antaresint.com



Y.027.3000001