

T.475.50

LS7...Multi-functional intelligent digital thermostats are designed for controlling speed fan and an on/off valve actuator in 2-pipe or 4-pipe FCU system, to meet up the adjusted indoor temperature.

Selection table:

Model	Description
LS7. 42	Basic type
LS7. 42R	Infrared remote control
LS7. 42H	Humiditymonitor
LS7. 42RH	Infrared remote control+ humiditymonitor
LS7. 50	Cooling valve+heating valve +three-gear fan control

Note:LS7.50 is 4-pipe system;other models are all 2-pipe system.

Features

- > Easy mounting
- > Large LCD display
- > Temperature humidity chips from Switzerland
- > Rotating temperature sensor
- > Low power consumption
- > ECO mode

Technical data:

Voltage: AC230V, 50Hz
 Load current: 2A (resistive loads), 1A (inductive load)
 Power consumption: < 1 W
 Terminal: A single terminal can max connect two 1.5 mm² or one 2.5 mm² wire
 Setting range: 5 ~ 35°C
 Ambient temperature: -10°C~55°C
 Protective housing: IP20

Explanation of symbols

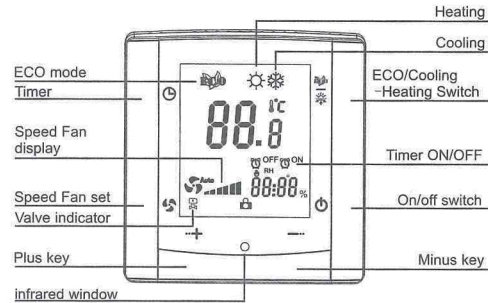

1. On/off
Press the key to switch on or switch off the thermostat.
2. Plus+ & minus -
Press the + / - to increase/ decrease your temperature setting point.
3. ECO mode
Short press key to enter into ECO mode, temperature and fan speed is in auto mode.
4. Cooling-heating Switch
Long press key can switch cooling/ heating mode.
5. Fan set
Press key to set fan speed, low, mid, high, auto.

6. Timer on/off
In On mode, Long press key to enter into Time Off mode, press +/- key to set time.
In Off mode, Long press key to enter into Time on mode, press +/- key to set time.

7. Key-lock
Press both + -key for 5 seconds to engage/disengage the key-lock function.

Advanced settings (Qualified person preferred)

Usually finish this operation in mounting.
 Press key simultaneously when in OFF mode, then enter into the advanced setting mode. Press key to enter into the advanced menu. Press key can quit the current work mode in advanced setting mode.

Item	Symbols	Explanation	+ or -
1		Modify temperature values	Adjust temperature values
2		ON/OFF mode	Display On shows entering ON mode when connecting power, OFF for off mode (Default)
3		Fan mode	ON: when reaching to the set temperature, the fan stops working; Off: when reaching to the set temperature, fan continue to work.
4		Heating mode	Default 20 °C
5		Cooling mode	Default 26 °C
6		Reset to factory setting	Long press + key

* ER1:temperature humidity sensor anomaly;ER0:inner sensor anomaly.

Dimension (mm)

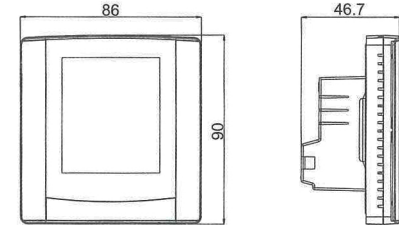

Mounting steps:

- 1 Turn the stator in clockwise direction to the position as shown in the picture below by a flat-blade screwdriver.

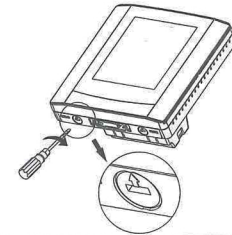

T.475.50

2 Remove the iron bracket from the back of thermostat by pushing downwards.

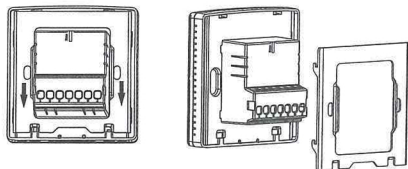

4 Insert thermostat into the bracket from top to bottom then turn the stator 180° by a flat-blade screwdriver to complete the installation.

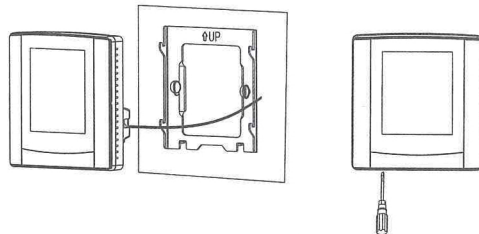

3 Fix the iron bracket to the cassette by screws and connect wires correctly according to the wiring diagram.

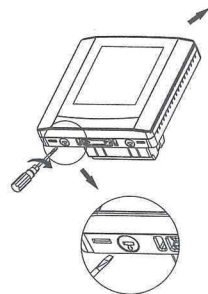
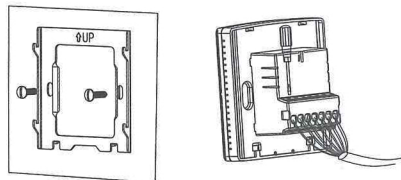

Wiring Diagram

1. Two-wire normally-closed actuator with FCU

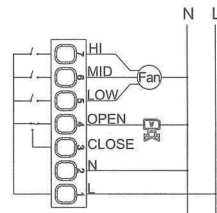

3. Three-wire double drive-by-wire actuator with FCU

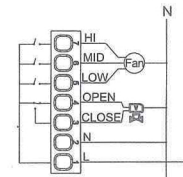

4. LS7.50 three-wire single drive-by-wire actuator with FCU

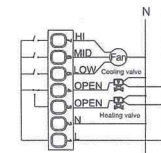

2. Three-wire single drive-by-wire actuator with FCU

